

型号 (TYPE): YFI

转造级库存螺杆系列 (Stock Rollde Ball Screw Series)

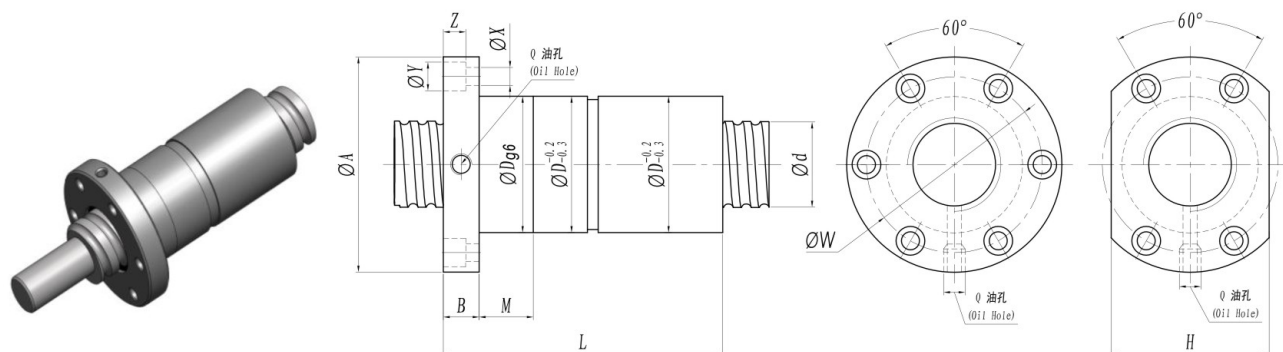

单位 (Unit): mm

I: 导程 Lead Da: 珠径 Ball Dia. n: 珠圈数 Number of Circuits

Ca: 动额定负荷 Basic Dynamic Rating Load (Kgf)

Coa: 静额定负荷 Basic Static Rating Load (Kgf)

型号 Model No.	滚珠丝杆, 螺母基准数据 Dimensions																
	d	l	Da	D	A	B	M	L	W	H	X	Y	Z	Q	n	Ca	Coa
YFI1604-3	15.3	4	2.381	30	52	10	12	72	38	34	4.5	8	4.5	M6X1	3	435	920
★ YFI1605-3	15	5	3	30	52	10	12	88	38	34	4.5	8	4.5	M6X1	3	765	1320
YFI2004-3	19.5	4	2.381	33	58	10	15	79	44	40	5.5	9	5.5	M6X1	3	600	1010
YFI2005-3	19	5	3	35	60	10	15	96	46	42	5.5	9	5.5	M6X1	3	1430	2150
YFI2010-3	19.35	10	3.175	36	60	10	15	98	46	42	5.5	9	5.5	M6X1	3	1050	1770
YFI2504-3	24.3	4	2.381	38	66	12	15	78	51	46	6.5	11	6.5	M6X1	3	610	1040
★ YFI2505-3	24	5	3	40	68	12	15	115	53	48	6.5	11	6.5	M6X1	3	1590	2720
YFI2510-3	24.5	10	3.969	42	70	12	15	135	55	50	6.5	11	6.5	M6X1	3	1120	2420
★ YFI3205-4	31.6	5	3.5	48	85	15	20	115	65	55	9	14	8.5	M8X1	4	2160	4000
YFI3210-3	31.6	10	5.556	52	87	15	20	152	67	56	9	14	8.5	M8X1	3	2550	4690
YFI3220-4	31	20	3.969	52	87	15	20	145	67	56	9	14	8.5	M8X1	4	2295	3706
YFI4005-5	39.58	5	3.5	55	90	15	20	120	70	59	9	14	8.5	M8X1	5	2910	6410
★ YFI4010-3	39.51	10	7.144	64	106	18	25	146	81	72	10.5	18	10.5	M8X1	3	3910	9520
YFI4020-3	38	20	6	64	106	18	25	195	81	72	10.5	18	10.5	M8X1	3	3790	6280
YFI5005-5	49	5	3.5	68	110	18	25	120	85	75	10.5	18	10.5	M8X1	5	3150	8030
YFI5010-4	49.31	10	7.144	75	117	18	25	178	92	80	10.5	18	10.5	M8X1	4	4340	9070
YFI5020-3	48.15	20	6.35	77	119	18	25	196	94	82	10.5	18	10.5	M8X1	3	4780	8750
YFI5040-2	48	40	6.5	77	119	18	25	156	94	82	10.5	18	10.5	M8X1	2	3210	5580
YFI6310-4	62.55	10	7.144	86	138	22	30	205	107	97	13	20	13	M8X1	4	7400	17860
YFI6320-3	62.55	20	7.144	95	146	22	30	208	116	100	13	20	13	M8X1	3	5320	11210
YFI8010-4	80	10	7.144	105	155	22	30	232	125	110	13	20	13	M8X1	4	8440	22710
YFI8020-4	80	20	12.7	125	165	22	30	315	145	130	13	20	13	M8X1	4	15226	35749

备注: 有标注★记号者可制作左旋螺纹

Note: with sign ★ can produce left helix