

## 丝杆轴端形状Screw end forms

## 类型51-52 Form 51-52

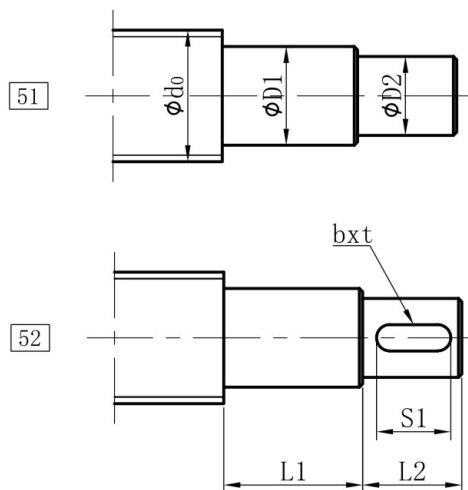

支撑座剖视图Application

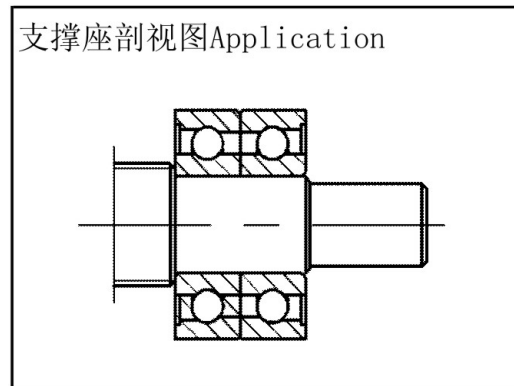

单位Unit: mm

类型 Form	滚珠丝杠规格		L1	D1	L2	D2 h7	键槽		
	Ball screw size						Keyway		
	$d_0$	P					S1	b P9	t +0.1
51	8	2.5	12	6 -0.005 -0.012	8	4	-	-	-
	12	4/5/10	16	8 -0.005 -0.012	9	6	-	-	-
	12	4/5/10/16	18	10 -0.005 -0.012	15	8	-	-	-
	16	4/5/10/20	20	12 -0.005 -0.014	15	10	-	-	-
	20	4/5/10/20	22	15 -0.005 -0.014	20	12	-	-	-
	20	4/5/10/25	24	17 -0.005 -0.014	23	15	-	-	-
	25	5/10/20/32	28	20 -0.005 -0.014	25	17	-	-	-
	30	5/10/20/40	30	25 -0.005 -0.015	30	20	-	-	-
	40	5/10/20/40	32	30 -0.005 -0.015	38	25	-	-	-
	50	5/10/12/20/40	36	40 -0.005 -0.015	50	35	-	-	-
52	16	4/5/10/20	20	12 -0.005 -0.014	15	10	12	3	1.8
	20	4/5/10/20	22	15 -0.005 -0.014	20	12	17	4	2.5
	20	4/5/10/25	24	17 -0.005 -0.014	23	15	20	5	3
	25	5/10/20/32	28	20 -0.005 -0.014	25	17	21	5	3
	30	5/10/20/40	30	25 -0.005 -0.015	30	20	25	5	3
	40	5/10/20/40	32	30 -0.005 -0.015	38	25	30	8	4
	50	5/10/12/20/40	36	40 -0.005 -0.015	50	35	40	8	4